

LEMON BAY PRESERVE

Wetland Restoration Project (Weir Modification)

INDEX TO DRAWING

DRAWING NO.	DRAWING DESCRIPTION
1	TITLE SHEET
2	WEIR DETAIL SHEET
3	SKIMMER DETAIL SHEET
4	EROSION CONTROL SHEET

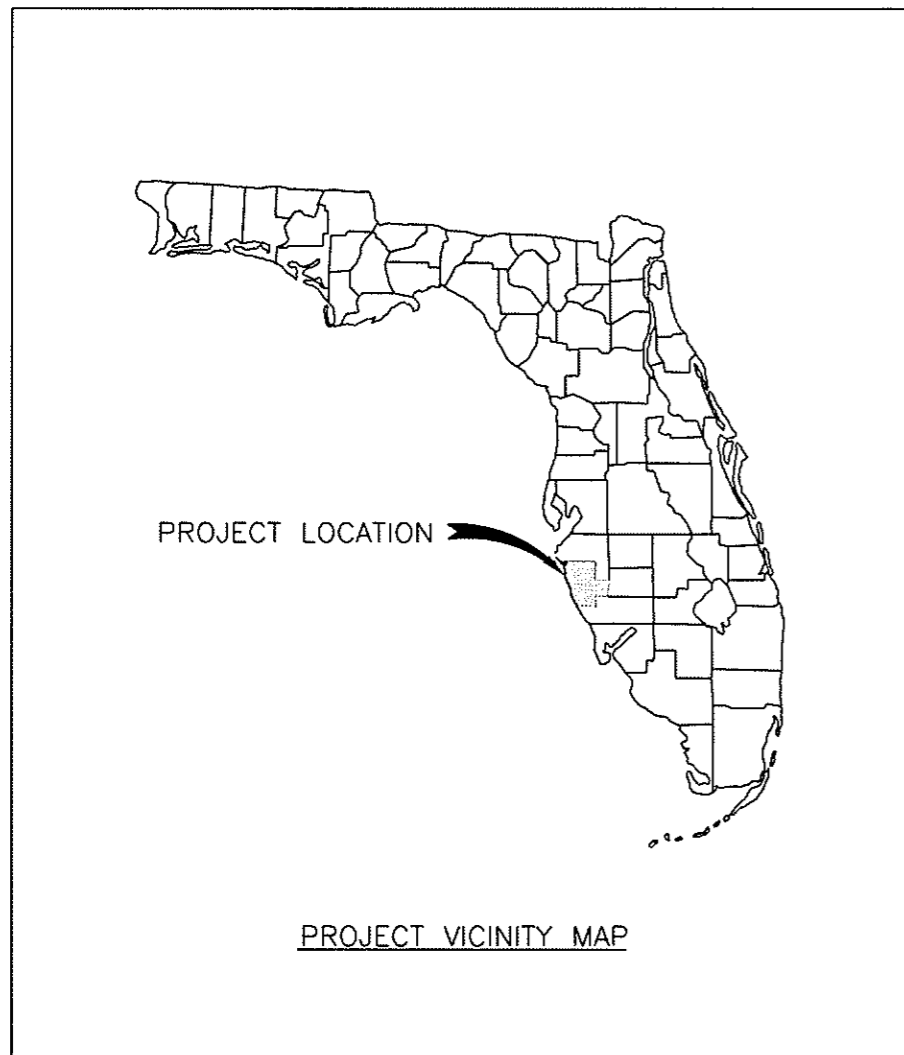

C.A.: JAMES LEY
 ESBC EXECUTIVE DIRECTOR: Robert Patten
 COUNTY COMMISSIONERS:
 NORA PATTERSON
 JOE BARBETTA
 SHANNON STAUB
 PAUL MERCIER
 JON THAXTON



SARASOTA COUNTY
 ENVIRONMENTAL SERVICES
 WATER RESOURCES
 1001 SARASOTA CENTER BLVD.,
 SARASOTA, FL 34240

PROJECT MANAGER: Mike Jones
 PHONE: 941-861-6251
 PROJECT ENGINEER: James P. Lamancusa, P.E.
 PHONE: 941-861-0599

SARASOTA COUNTY
 SARASOTA, FLORIDA

PROJECT LOCATION

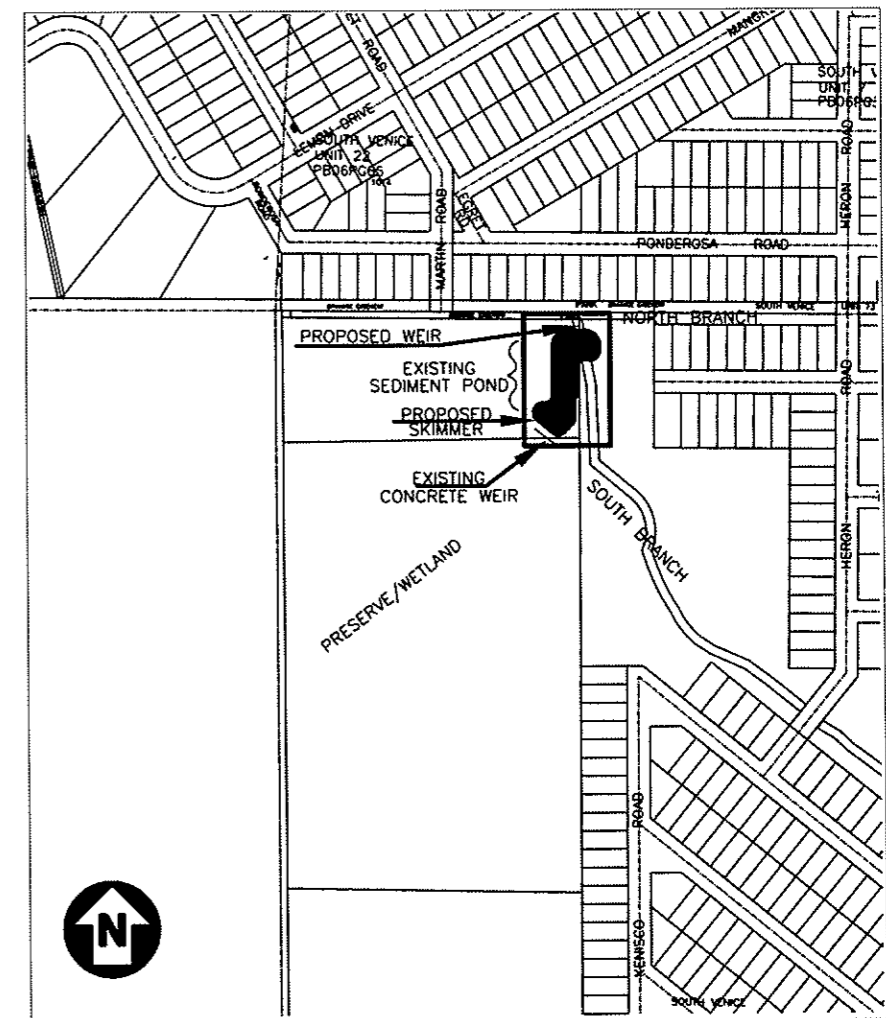

PROJECT LOCATION MAP
 SEC. 4 TWP. 40 RNG. 19

SKIMMER

NTS

CONSTRUCTION PART "A"

INSTALL 12" THICK (D₅₀=6" MIN) RIP-RAP IN FRONT OF NEW SKIMMER

END SECTIONS TO BE FIELD LOCATED

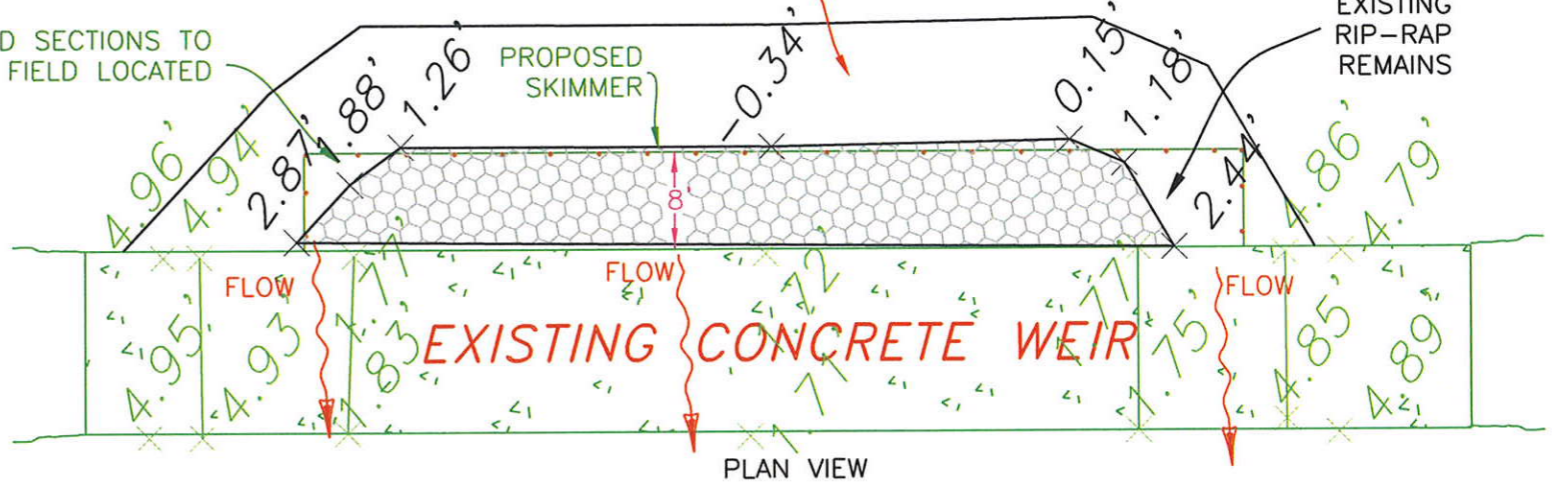

ARROWS SHOW EXISTING FLOW PATH - TO BE REDIRECTED DURING CONSTRUCTION

SECTION C-C

NOT TO SCALE

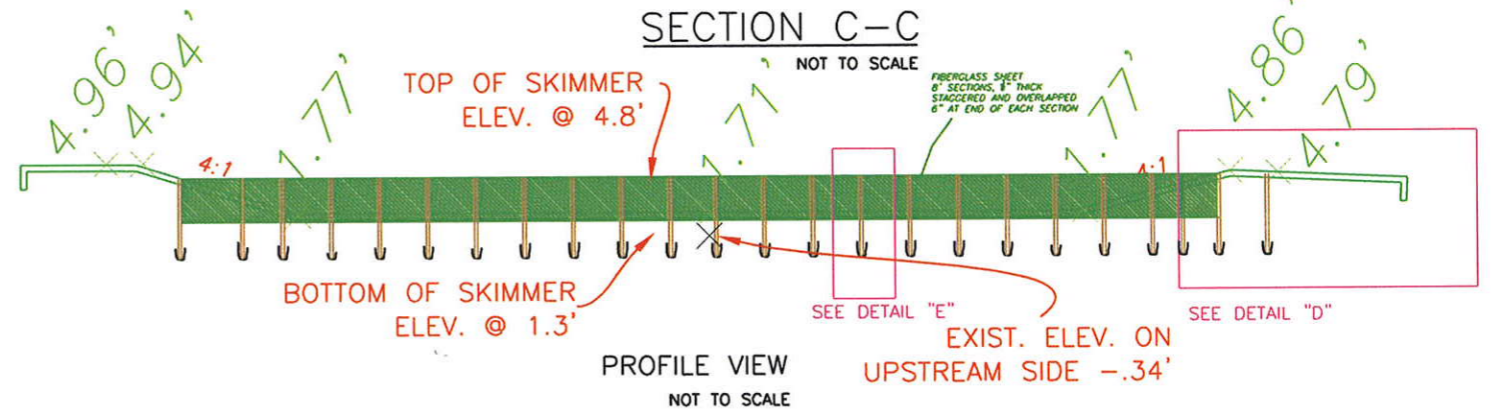

PROFILE VIEW
NOT TO SCALE

LOCATION OF PROPOSED SKIMMER

APPROX LOCATION OF TURBIDITY BARRIER DURING CONSTRUCTION

EXIST CONC WEIR

APPROX LOCATION OF SEDIMENT CONTROL

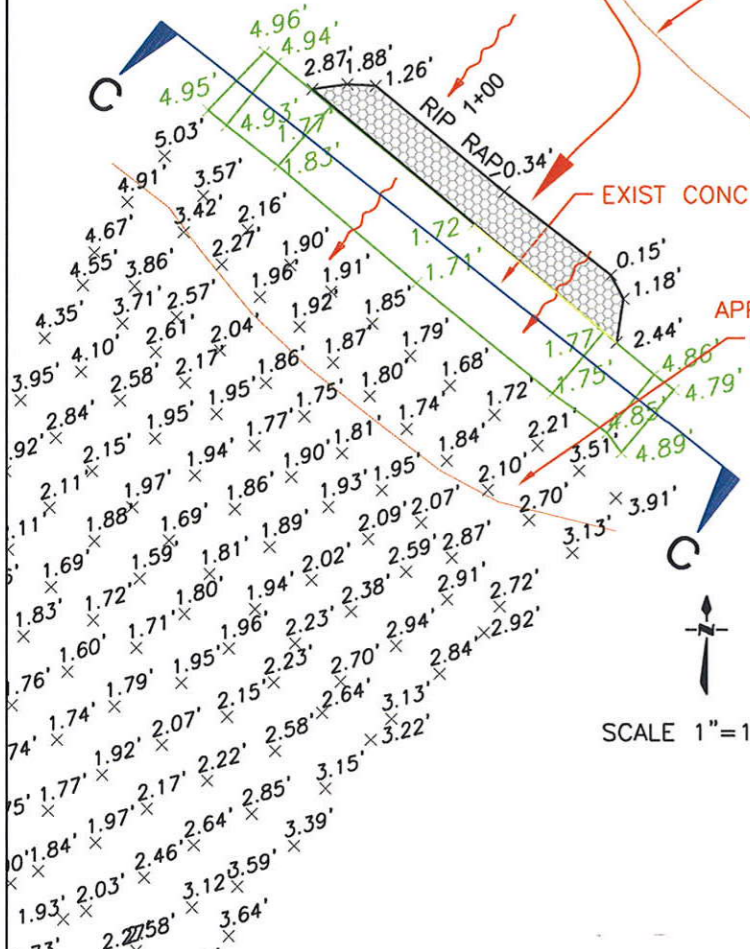

SCALE 1"=16'

Place Turbidity Barrier during construction of skimmer (PART "A") such that South Branch pools then flows to North Branch in high water conditions

DETAIL "D"

NOT TO SCALE

DARK OLIVE GREEN FIBERGLASS SHEET
3/8" THICK-OVERLAP AND SECURE TO POSTS USING 316 STAINLESS OR LIKE PRODUCT

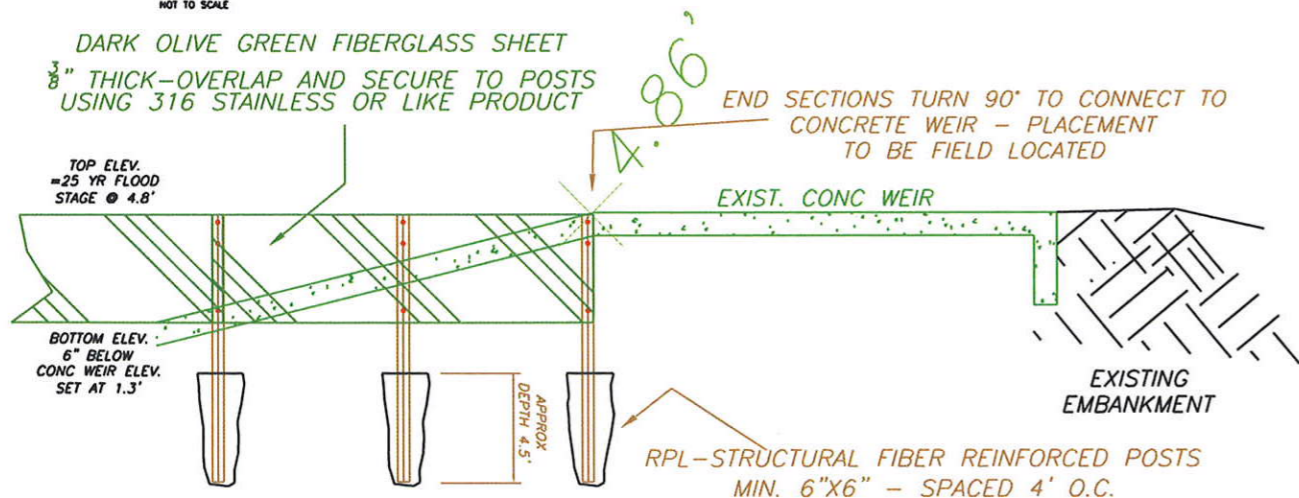

DETAILS

DETAIL "E"

VIEW FROM EAST SIDE
NOT TO SCALE

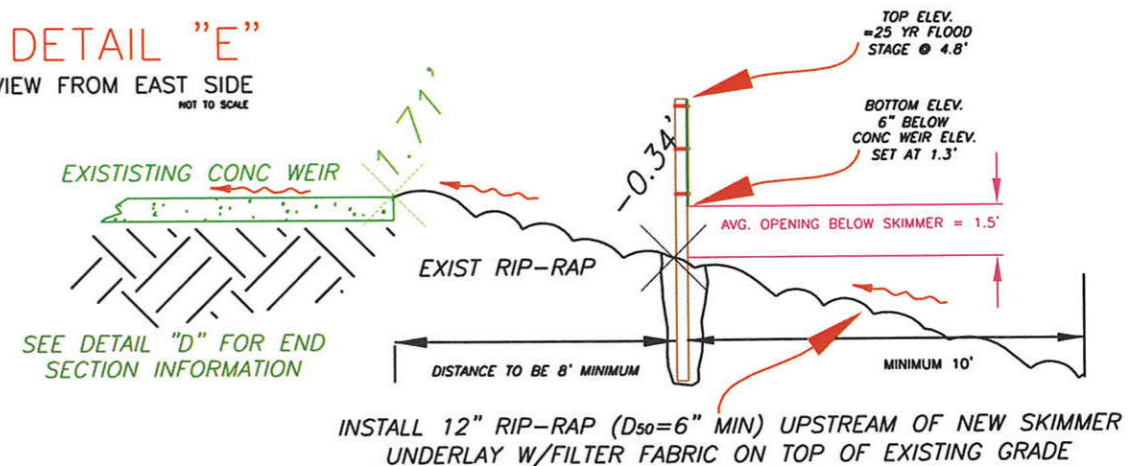

SARASOTA COUNTY
WATER CORE SERVICES / ENV. SERVICES
1001 SARASOTA CENTER BLVD. SARASOTA, FLORIDA 34240
JAMES LAMANCUSA, P.E. TEL: 941/861-0599 * FAX: 941/861-0986

CONSTRUCTION
PART "A"

ABBREVIATION LEGEND	
P.B. = PLAT BOOK	P.I.D. = PROPERTY IDENTIFICATION
CONC. = CONCRETE	NO. = NUMBER
W.C. = WOOD CORE	R.C.P. = REINFORCED CONCRETE PIPE
R/W = RIGHT-OF-WAY	C.M.P. = CORRUGATED METAL PIPE
FOUND = FOUND	T.O.S. = TOP OF SLOPE
PL = PLAT	T.O.B. = TOP OF BANK
MEAS. = MEASURED	O.T. = OPEN TRENCH
PAZ = PAZ	F.L. = FLORIDA POWER & LIGHT
R.P.B. = ROAD PLAT BOOK	ME. = METER
C.B.C. = OFFICE RECORDS BOOK	CATV = CABLE TELEVISION
	R = RADIUS

SYMBOL LEGEND	
○ = H.H. & DISK FOUND	○ = UTILITY POLE
□ = CONCRETE MONUMENT FOUND	○ = FIRE HYDRANT
○ = IRON ROD & CAP FOUND	○ = METER
○ = IRON ROD FOUND	○ = MANHOLE
○ = IRON PIPE FOUND	○ = SERVICE BOX
○ = H.H. & DISK SET	○ = CONTROL BOX
○ = CHECK OUT FOUND	○ = U/D VERSION
○ = IRON ROD & CAP SET	○ = TRANSFORMER
○ = BACKFLOW	○ = BACKFLOW
○ = STAMPED TRIM PT.	○ = BACKFLOW
○ = SIGN	○ = LABEL, SOIL BORING

SYMBOL LEGEND	
○ = OAK TREE	○ = BARBED WIRE FENCE
○ = PINE TREE	○ = WOOD FENCE
○ = PALM TREE	○ = HOODIE FENCE
○ = CEDAR	○ = GATE
○ = MAPLE TREE	○ = PVC FENCE
○ = BUSH	

LEMON BAY
Wetland Restoration
Weir Modification

James P. Lamancusa
State of Florida
P.E. Number: 57290

DWG DATE: 12/4/06	SHEET NO. 3
FIELD DATE: 4-3-06	of 4
DRAWN BY: D.J.	
CHECKED BY: J.M.	

CONSTRUCTION PART "B"

